

Technical Manual

JBL STX815M

SPECIFICATIONS



ACOUSTIC & ELECTRICAL SPECIFICATIONS:

- Nominal Impedance:
 - Passive: 8 Ohms
 - Bi-amp LF: 8 Ohms
 - Bi-Amp HF: 8 Ohms
- Power Rating: Continuous Pink Noise / Program / Peak:
 - Passive: 800W / 1600W / 3200W
 - Bi-amp LF: 800W / 1600W / 3200W
 - Bi-amp HF: 75W / 150W / 300W
- Frequency Response: 55 Hz - 20 kHz (± 3 dB)
- Frequency Range: 41 Hz - 20 kHz (-10 dB)
- Maximum SPL: 131 dB SPL peak
- System Sensitivity: 96 dB SPL (passive mode)
(1 Watt @ 1 Meter)
- Crossover Freq.: 1.8 kHz

SYSTEM COMPONENTS:

- Cabinet: Enclosure (Not For Sale)
- Grille: 5013221
- Low Frequency: 2226HPL, 380 mm (15 in) Vented Gap
- Transducer: Cooler™ woofer

SYSTEM COMPONENTS: CONT'D

- DC Resistance: 5.0 ohms
- High Frequency: 2432H, 75 mm (3 in) neodymium-magnet Transducer: compression driver
- DC Resistance: 4.00 ohm \pm 0.2 ohm
- Crossover Network: 5014362

AURAL SWEEP TEST SPECIFICATIONS:

- A. System Aural Sweep Test: 7.0V Input, 10 Hz to 20 kHz
- B. L.F. Aural Sweep Test: 10.0V Input, 20 Hz to 1.2 kHz
- C. H.F. Aural Sweep Test: 3.0V Input, 300 Hz to 1.0 kHz

PHYSICAL SPECIFICATIONS:

- Enclosure Dimensions: 721 x 436 x 329 mm D
(28.4 x 17.2 x 13.0 in. D)
- Net Weight: 58 lb (26 kg.)

WARRANTY INFORMATION:

- Refer to Warranty Statement packed with each product.

PACKAGE

Warranty 59660

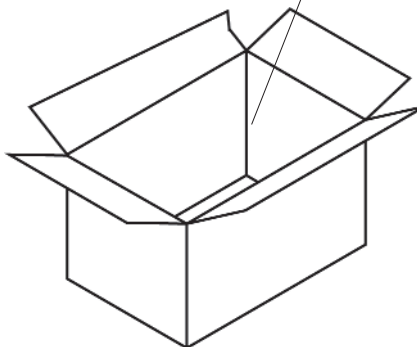
Spec Sheet
5022490Carton
5018296Filler, Top
5018297Filler, Bottom
5018298PKG, Microfoam (8)
49790P

WIRING DIAGRAM

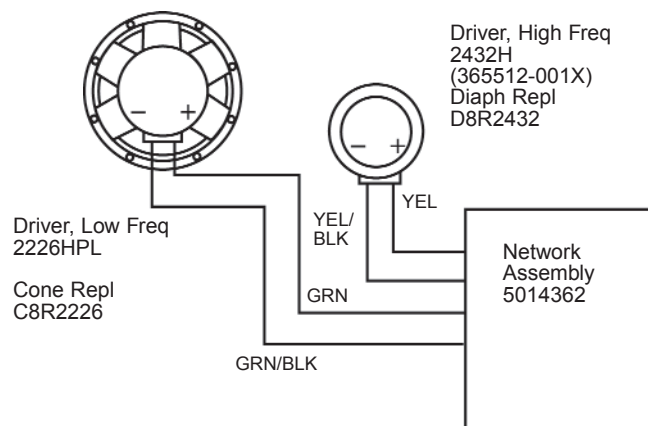

SEE NETWORK SCHEMATIC PAGE 2

NOTE: INDIVIDUAL PARTS FOR THE ABOVE CROSSOVER ARE NOT AVAILABLE.
A COMPLETE REPLACEMENT ASSEMBLY SHOULD BE ORDERED.

JBL STX815M

COMPONENT EXPLODED VIEW

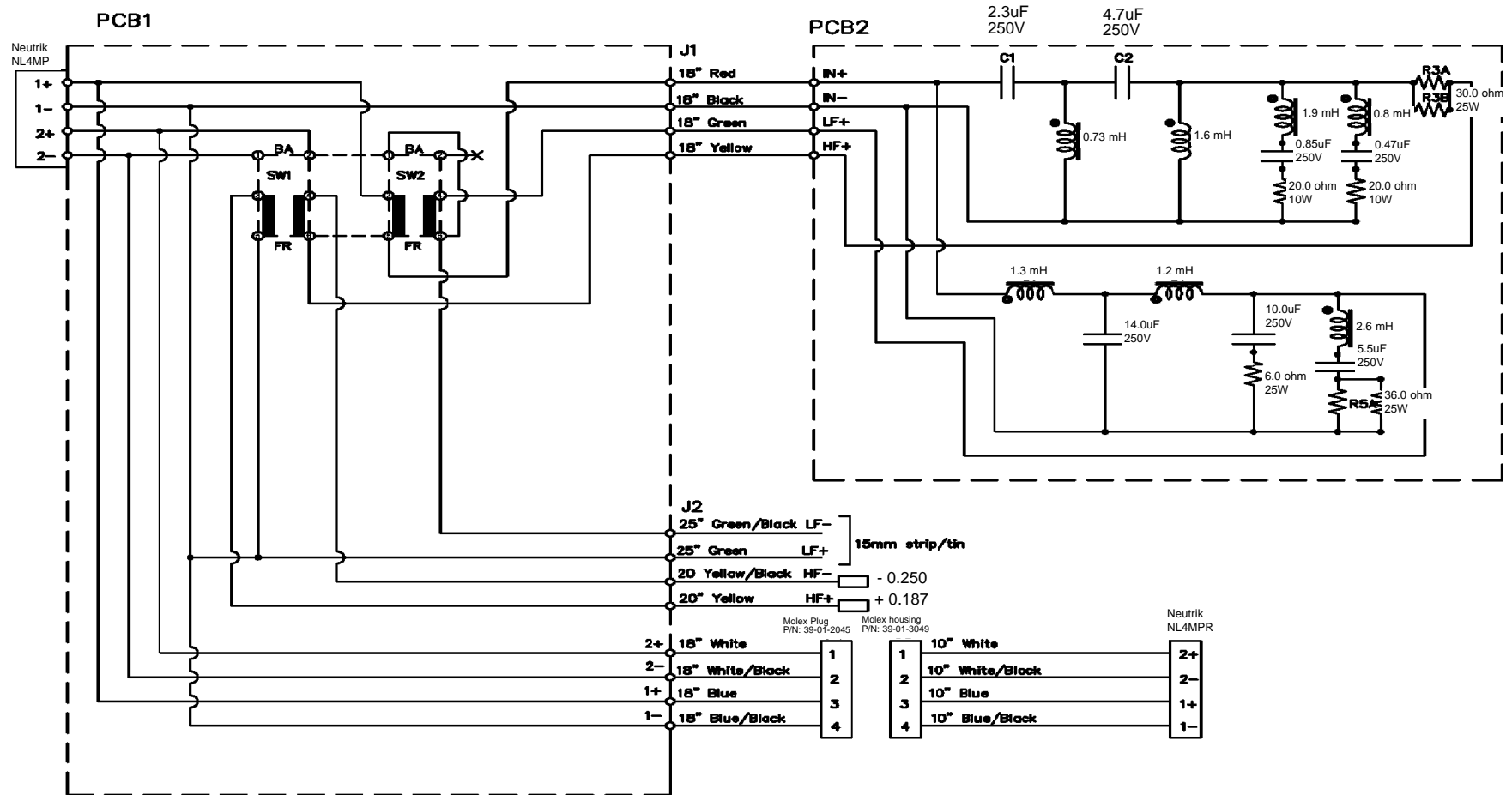

NOTE: INDIVIDUAL PARTS FOR THE ABOVE CROSSOVER ARE NOT AVAILABLE.
A COMPLETE REPLACEMENT ASSEMBLY SHOULD BE ORDERED.

JBL STX815M

JBL STX815M

COMPONENT EXPLODED VIEW

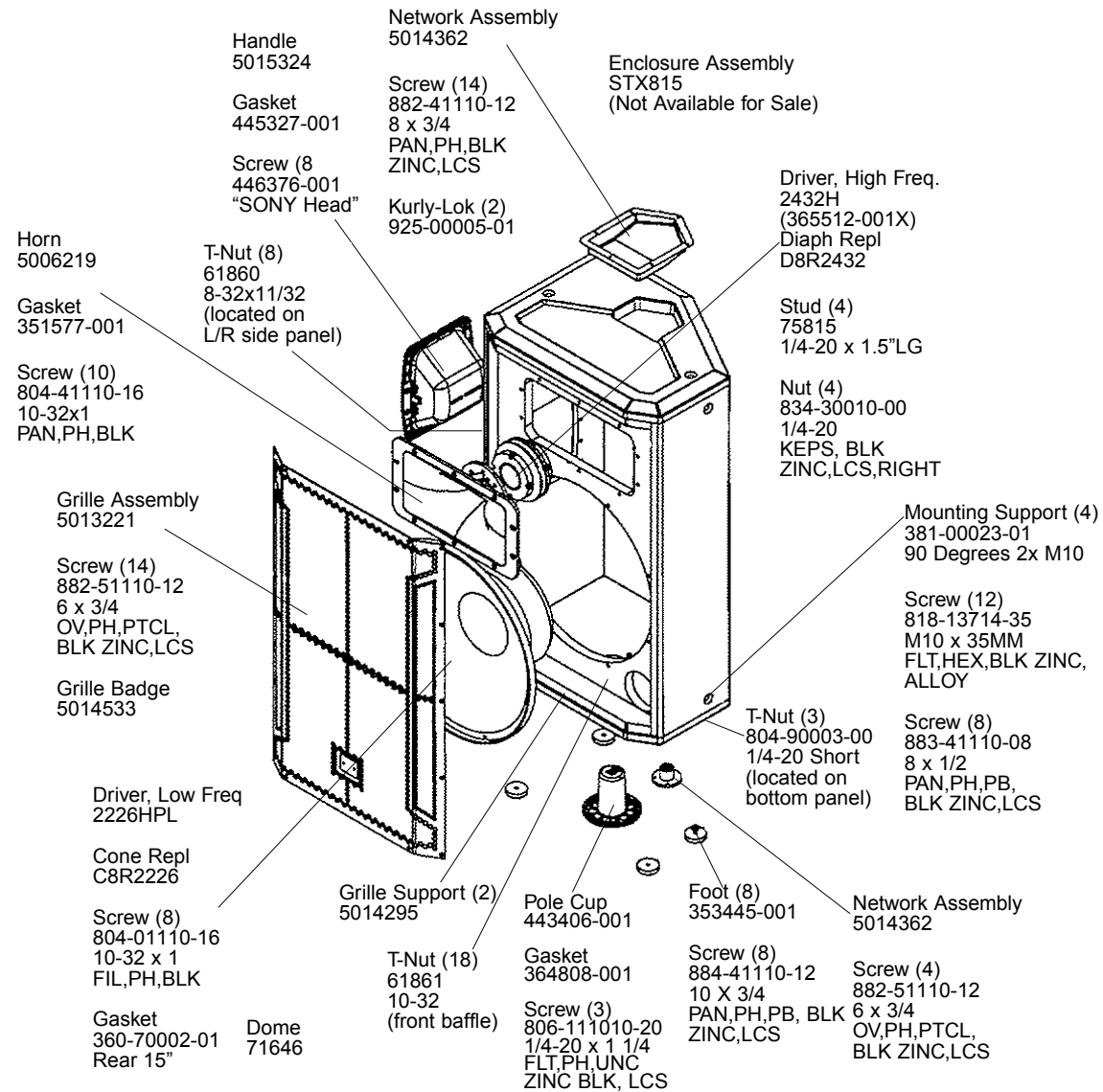

JBL STX815M