

Technical Manual

JBL SRX818SP/230

SPECIFICATIONS



ACOUSTIC & ELECTRICAL SPECIFICATIONS:

- Frequency Response (± 3 dB): 35 Hz – 120 Hz
- Frequency Range (-10 dB): 29Hz - 150Hz
- Maximum SPL Output: 135 dB
- Input Impedance: 40k balanced, 20k unbalanced
- Crossover Frequency: 80 Hz
- AC Power Cons. (120V~): 2.2A (1/8th Power), 5.6A (1/3rd Power)

SYSTEM COMPONENTS:

- Cabinet: Enclosure (Not For Sale)
- Grille: 5049365
- Low Frequency Driver: 2279F, 18 inch (460mm) woofer
- D.C.Resistance: 1.4 ohm \pm 10%

AURAL SWEEP TEST SPECIFICATIONS:

- A. System.Aural Sweep Test: 0.25V Input, 40 Hz to 200 Hz Knob Fully Clockwise to 12 dB
- B. L.F.Aural Sweep Test: 7.0V Input, 10 Hz to 100 Hz

PHYSICAL SPECIFICATIONS:

- Enclosure Dimensions: (HxWxD) 683mm x 684mm x 575mm D (26.89" x 26.92" x 22.62" D)
- Net Weight: 87.0 lbs (39.5 kg)

WARRANTY INFORMATION:

- Refer to Warranty Statement posted on line.

PACKAGE

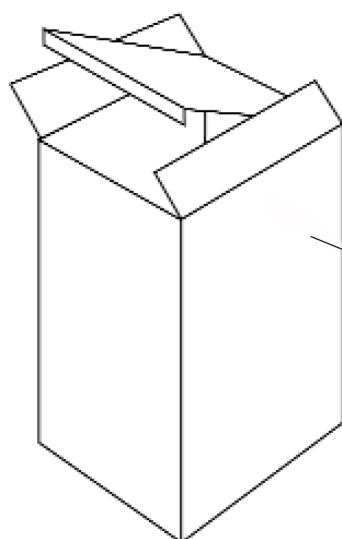

Warranty Card
59660

Quickstart Guide
5056240

Carton
5050029

Filler (2)
5050030

PKG, Microfoam (8)
49790P

Line Cord, Latching
5054101 (120V)
5055626 (230V)

WIRING DIAGRAM

Driver, Low Frequency
2279F
(5048249X)
C2R2279

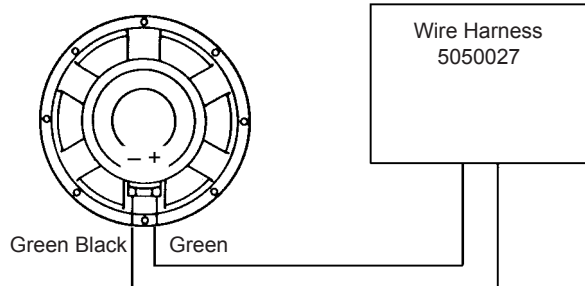

SCHEMATIC

| | | |
|---|--------------------|--------------|
| 1 | - NOT USED | |
| 2 | - NOT USED | |
| 3 | 1065MM GREEN | STRIPPED END |
| 4 | 1065MM GREEN/BLACK | STRIPPED END |

JBL SRX818SP/230 REV A

JBL SRX818SP/230

COMPONENT EXPLODED VIEW

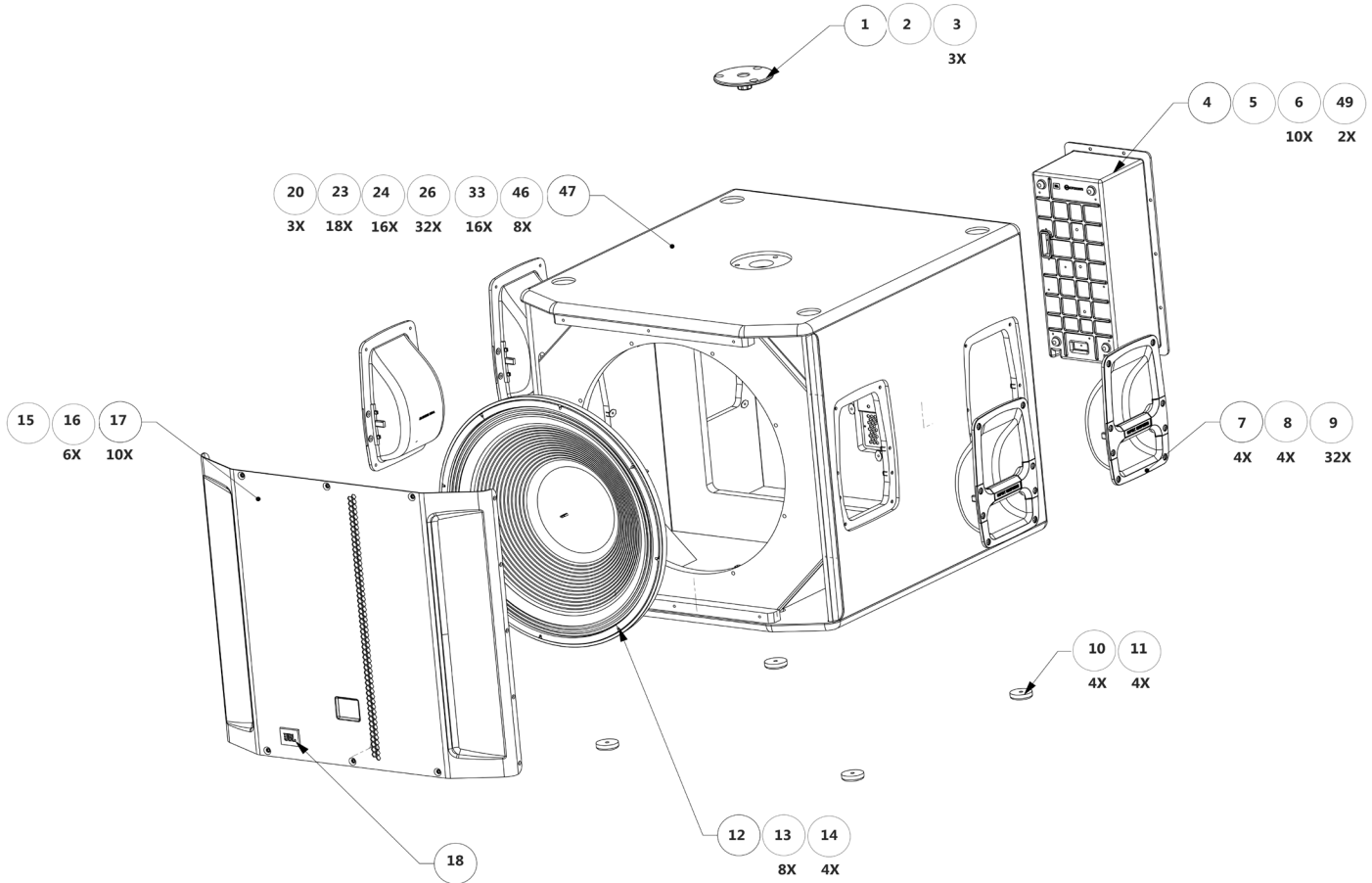

COMPONENT PARTS LIST:

| | Part No. | Qty | Description |
|----|--------------|-----|---|
| 1 | 5003856 | 1 | POLE MOUNT, M20 3 HOLE PATTERN |
| 2 | 364808-001 | 1 | GASKET, POLE CUP |
| 3 | 806-11010-20 | 3 | SCR, 1/4-20 X 1 1/4, FLT, PH, UNC, BLK ZNC, L |
| 4 | 5069594X | 1 | AMPLIFIER, SRX818P |
| 5 | 5050027 | 1 | WIRING HARNESS, SRX818SP |
| 6 | 804-11110-12 | 10 | SCR, 10-32 X 3/4", FLT, PH, BLK ZINC, LCS |
| 7 | 5048154 | 4 | HANDLE CUP ASSY SRX818SP |
| 8 | 5048939 | 4 | GASKET HANDLE |
| 9 | 446376-001 | 32 | SCREW, #8-32, HANDLE |
| 10 | 353445-001 | 4 | FOOT, SRX |
| 11 | 884-41110-12 | 4 | SCR, 10 X 3/4, PAN, PH, PB, BLK ZINC, LCS |
| 12 | 5048249X | 1 | M/I, 2279F |
| 13 | 804-01110-20 | 8 | SCR, 10-32X1-1/4, FIL, PH, BK |
| 14 | 60578 | 4 | WOOFER GASKET (4PCS = 1 GASKET) |

| | Part No. | Qty | Description |
|----|--------------|-----|---|
| 15 | 5049365 | 1 | GRILLE ASSEMBLY SRX818SP |
| 16 | 882-41110-12 | 6 | SCR, 6X3/4", PAN, PH, PB, BLK |
| 17 | 882-51110-12 | 10 | SCR, 6 X 3/4, OV, PH, PTCL, BLK ZC, LCS |
| 18 | 5056661 | 1 | LOGO SRX800 |
| 20 | 804-90003-00 | 3 | T-NUT, 1/4-20 X 5/16, 4 PRONG, CLR ZINC |
| 23 | 352214-001 | 18 | T-NUT, 10-32, SPECIAL, PRO |
| 24 | 835-44051-00 | 16 | NUT, 5/16-18, T-NUT, NO FIN, MCS, RIGHT |
| 26 | 61860 | 32 | T-NUT 8-32X11/32 |
| 33 | 807-31010-12 | 16 | SCR, 5/16-18 X 3/4, TRS, PH, UNC, BLK ZINC, L |
| 46 | 61861 | 8 | T-NUT, 10-32 |
| 47 | 5055900 | 1 | SCR, 6/32 X 7/8 PHIL PAN EXT SEMS CLR |
| 49 | 5057024 | 2 | AMP GASKET, SRX800, 3M 9828 ADHESIVE |

JBL SRXS18SP/230

COMPONENT EXPLODED VIEW: 5069594X

COMPONENT PARTS LIST:

[illegible][illegible]