

Technical Manual

JBL STX828S

SPECIFICATIONS



ACOUSTIC & ELECTRICAL SPECIFICATIONS:

- Nominal Impedance:
 - Parallel: 4 Ohms
 - Discrete: 8 Ohms x 2 Ohms
- Power Rating: Continuous / Program / Peak:
 - Parallel: 2000W / 4000W / 8000W
- Frequency Response: 37 Hz - 120 Hz (± 3 dB)
- Frequency Range: 32 Hz - 250 Hz (-10 dB)
- Maximum SPL: 138 dB SPL peak
- System Sensitivity: 99 dB SPL (1 Watt @ 1 Meter)
- Recommended Crossover
 - Frequencies: 30 Hz, 24 dB / octave HPF
 - 80 Hz, 24 dB / octave LPF

SYSTEM COMPONENTS:

- Cabinet: Enclosure (Not For Sale)
- Grille: 5013222
- Low Frequency Transducer: (2) 2242HPL, 457 mm (18 in) Super Vented Gap Cooled™ woofers
- DC Resistance: 4.7 ohm

SYSTEM COMPONENTS: (CONT'D)

- Terminal Cup: 353601-001

AURAL SWEEP TEST SPECIFICATIONS:

- A. System Aural Sweep Test: 10.0V Input, 20 Hz to 20 kHz
- B. L.F. Aural Sweep Test: 7V Input, 20 Hz to 1000 Hz

PHYSICAL SPECIFICATIONS:

- Enclosure Dimensions: 564 x 1137 x 714 mm D (22.2 x 44.8 x 28.1 in. D)
- Net Weight: 180 lb (82 kg.)

WARRANTY INFORMATION:

- Refer to Warranty Statement packed with each product.

PACKAGE

Warranty 59660

Spec Sheet
5022493

Carton
5018505

Filler (2)
5018506

PKG, Microfoam (8)
49790P

Tray (2)
5022559

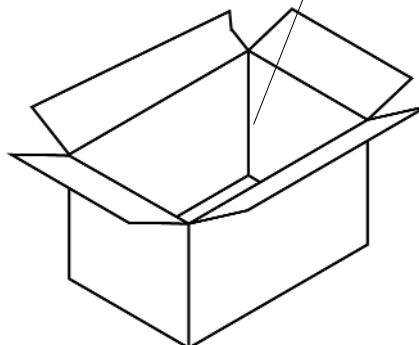

WIRING DIAGRAM

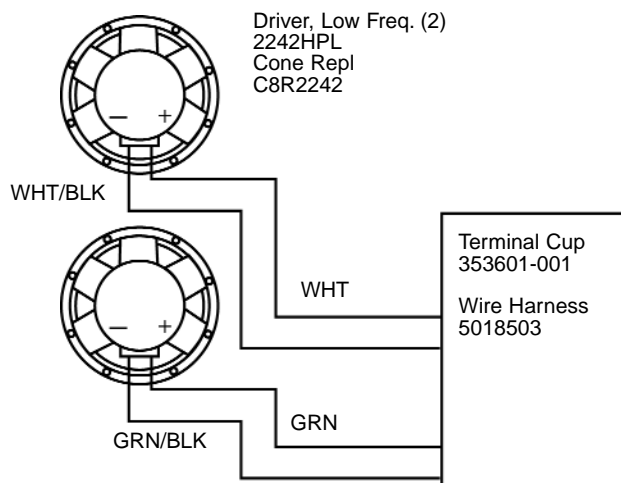

Wire Harness Diagram - 5018503

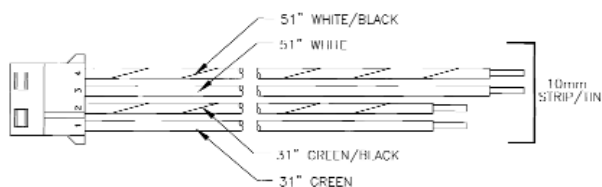

NOTE: INDIVIDUAL PARTS FOR THE ABOVE CROSSOVER ARE NOT AVAILABLE. A COMPLETE REPLACEMENT ASSEMBLY SHOULD BE ORDERED.

JBL STX828S REV B

COMPONENT EXPLODED VIEW

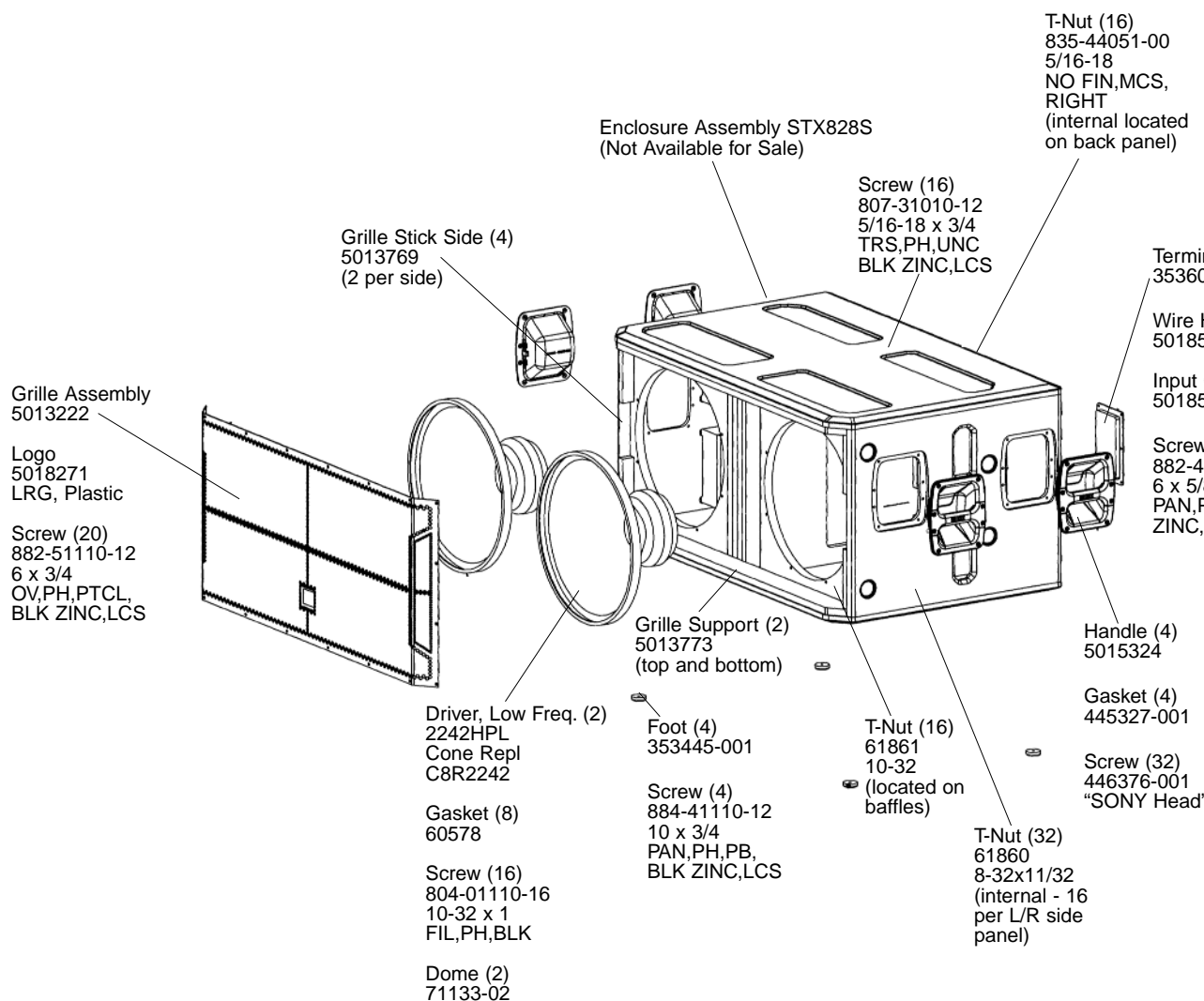

JBL STX828S